



# INFLOW

# BALL VALVES

PRODUCT DESCRIPTION : Floating Type 3 Way Screwed End Ball Valve

SERIES : FJ3W

STANDARDS FOLLOWED Manufacturing : BS- EN ISO 17292/API 6D Testing : BS-6755/API 6D

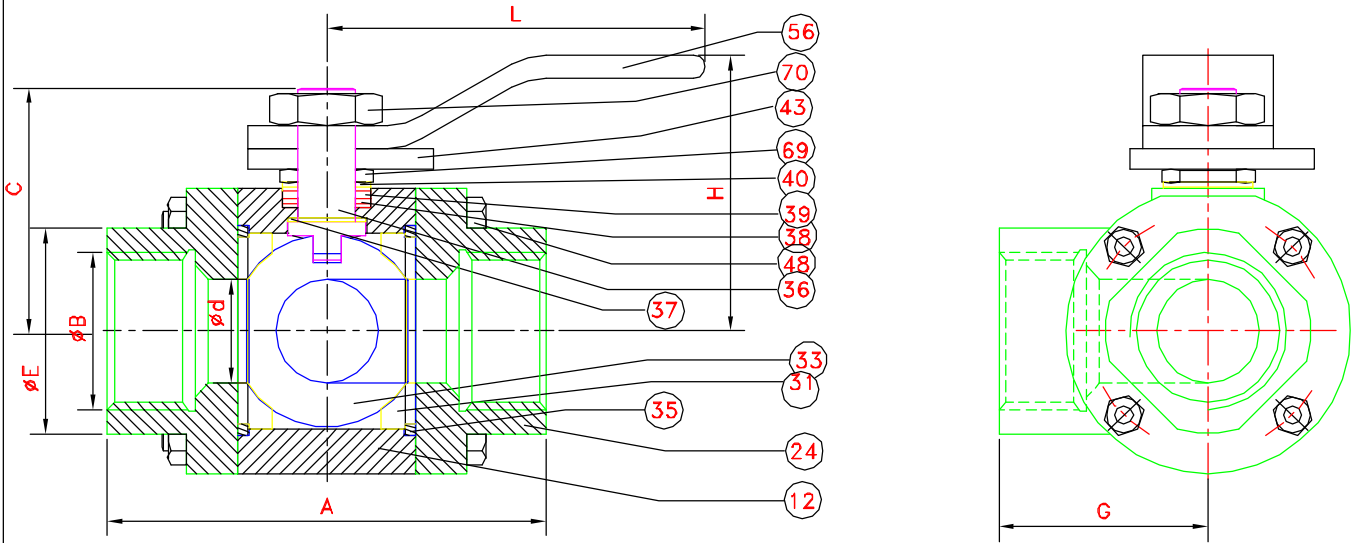

Part No	Part Name	Material Code							SPECIFICATION OF MATERIAL				
		A	B	C	D	I	J	O					
12	Body	A	B	C	D	I	J	O	A=CS(BS)ASTM A216 Gr WCB	O=ASTM A 352 Gr LCB			
24	Pipe End	A	B	C	D	I	J	O	B=ASTM A 351 Gr CF8	P=ASTM A 217 Gr CA15			
33	Ball	E	B	C	D	I	J	F	C=ASTM A 351 Gr CF8M	E=AISI - 304			
36	Stem	J	E	F	D	I			D=ASTM A 351 Gr CN7M	F=ASISI - 316			
39	Gland	J	E	F	D	I			I=ASTM A 494 N 12MV	GFT= GLASS FILLED TEFLON			
31	Seat	PTFE	GFT	POM					J=ASTM A 494 CW 12MW				
38	Stem Seal	PTFE	GRAFOIL	GFT					Dimension Details				CLASS
40	Spring Disc	SPRING STEEL			NOMINAL	15	20	25	32	40	50	800	
37	Disc Bearing	GFT			SIZE	RP	FB	RP	FB	RP	FB		RP
69	Gland Nut	STEEL			A	65	65	71	94	106	115		
43	Stopper Plate	STEEL			B	9.5	12.5	19	25	32	38		
44	Lever	STEEL			C	30.5	33	42	50	55	70		
48	BODY BOLT, NUT	STEEL	H.T. Gr. 8.8		D	46	56	70	76	87	92		
35	Body Seal	PTFE	SWG		E	112	112	146	146	178	178		
70	Lever Nut	STEEL	H.T. Gr. 8.8		G								

TESTING DETAILS

CLASS	HYDROSTATIC		PNEUMATIC SEAT
	SHELL	SEAT	
800	211 Kg/cm <sup>2</sup>	69 Kg/cm <sup>2</sup>	

ALL DIMENSIONS ARE IN mm

1. DUE TO CONTINUOUS DEVELOPMENT PROGRAM DIMENSIONS ARE SUBJECTED TO CHANGES WITHOUT ANY FURTHER NOTICE
2. OTHER MATERIALS UPON REQUEST.

CUSTOMER : ULTRA PRECISION FILTERS INDIA PVT. LTD.

ENQUIRY/ORDER NO: VERBAL

JOB PROJECTS :

OUR REF NO : FCE:CU02:2003-04:227

CERTIFICATION SEAL

MANUFACTURERS : **FLOW CONTROL ENGINEERS**

D-66, GOVT. INDUSTRIAL ESTATE  
BELGAUM - 590 008.